

CIFIAL

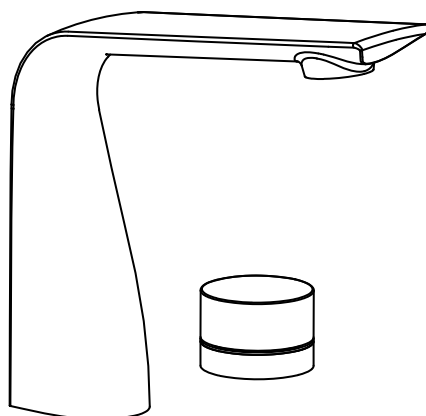

Single-lever Digital Basin Mixer

Note for Installation:

- 1 The internal components have been installed and tested in the factory. Please do not disassemble by yourself to avoid negative influence on the life of the mixer.
- 2 Before installation of the mixer, please ensure the main valve is open, to flush the impurities such as steel wire in the water pipe, to prevent the mixer from being blocked and consequent negative impact on flow rate and function.
- 3 Please install as per the installation manual, to ensure the operation is correct. Do not assemble by force to prevent damages to the components of the mixer.
- 4 Please ensure the connection between the mixer and the hot&cold main is correct. When faced with user, the left side of the mixer shall be connected with hot main and the right side connected with the cold main.
- 5 After installation of the mixer, please check the tightness of each junction to ensure no leakage between the mixer and the water pipe connector. Reopen the main inlet control to flush the pipe for 1 min.
- 6 For further inquiries, please contact directly with the local dealers.

Instructions

To remain the shineness of the mixer, please follow the below:

- 1 For normal use of the mixer, only water and soft cloth is needed to clean and dry it.
It's better to remove all the remaining water on the tap everyday!
- 2 If there is smudginess on the mixer that is hard to remove, soft liquid cleanser or neutral glass lotion shall be applied for cleaning. After cleaning, please use water to rinse the mixer and soft cloth to dry it.
- 3 Do not use those liquid cleanser that might cause abrasion, sandcloth or hard tools to rub the mixer.
- 4 Do not use any acid or crude liquid cleanser, soap or abrasive material for increasing the shineness, to clean the mixer.

Reminder

There are different kinds of mixers that shall be opened by various ways, such as open and close by single handle, swiveled by single handle or by dual handles; And different kinds of divertors shall be opened either by push, or by pull, or by swivel, or by swivel movement of the spout. Fixed positions are set for different functions. Do not pull and push by force to avoid damages to the functions of the mixer.

Thank you for purchasing this products. The internal structural parts of the faucet have been professionally installed and tested at the factory to provide long term use under normal conditions. This product is easy to install using basic tools and our easy to follow illustrated instructions.

1 NOTES FOR INSTALLATION

- 1) Please do not connect the hot and cold water supply lines in reverse. This could result in hot water flow from cold line and cause scalding.
- 2) The temperature of hot water shall not exceed 85 °C . Exceeding 85 °C may cause scalding, the service life of faucets might be shortened, or the faucet might be damaged.
- 3) After the installation, please make sure the faucet is securely mounted.

 **Warning :** Read all the instructions completely before proceeding. We recommends calling a professional if you are uncertain about installing this product!

2 DIMENSIONS(mm)

Take reference to Page 1

3 PARTS IN THE BOX

If any of these parts are missing, please contact the customer service.

4 SHUT OFF THE WATER SUPPLY

Find the water valve and close it. Normally it should be near the water meter.

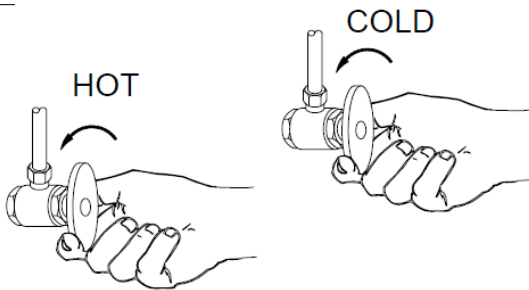

5 TOOLS RECOMMENDED

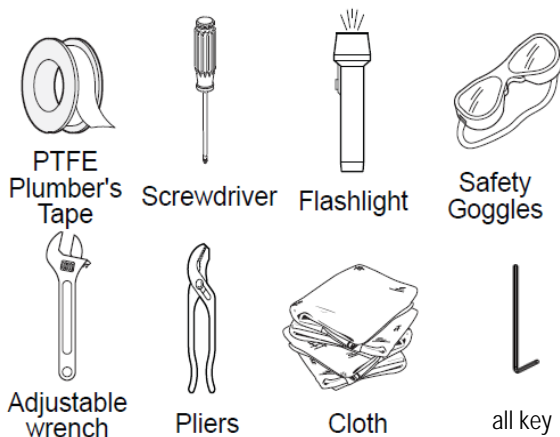

6 Install Faucet

First assembly the stud bolt (6B) and flexible hoses (6C) with the tap (6A) separately. Screw out the nut and the gasket, and take them go through the hole on the deck. Then pass the wire of body (6D) through the hole beside the tap.

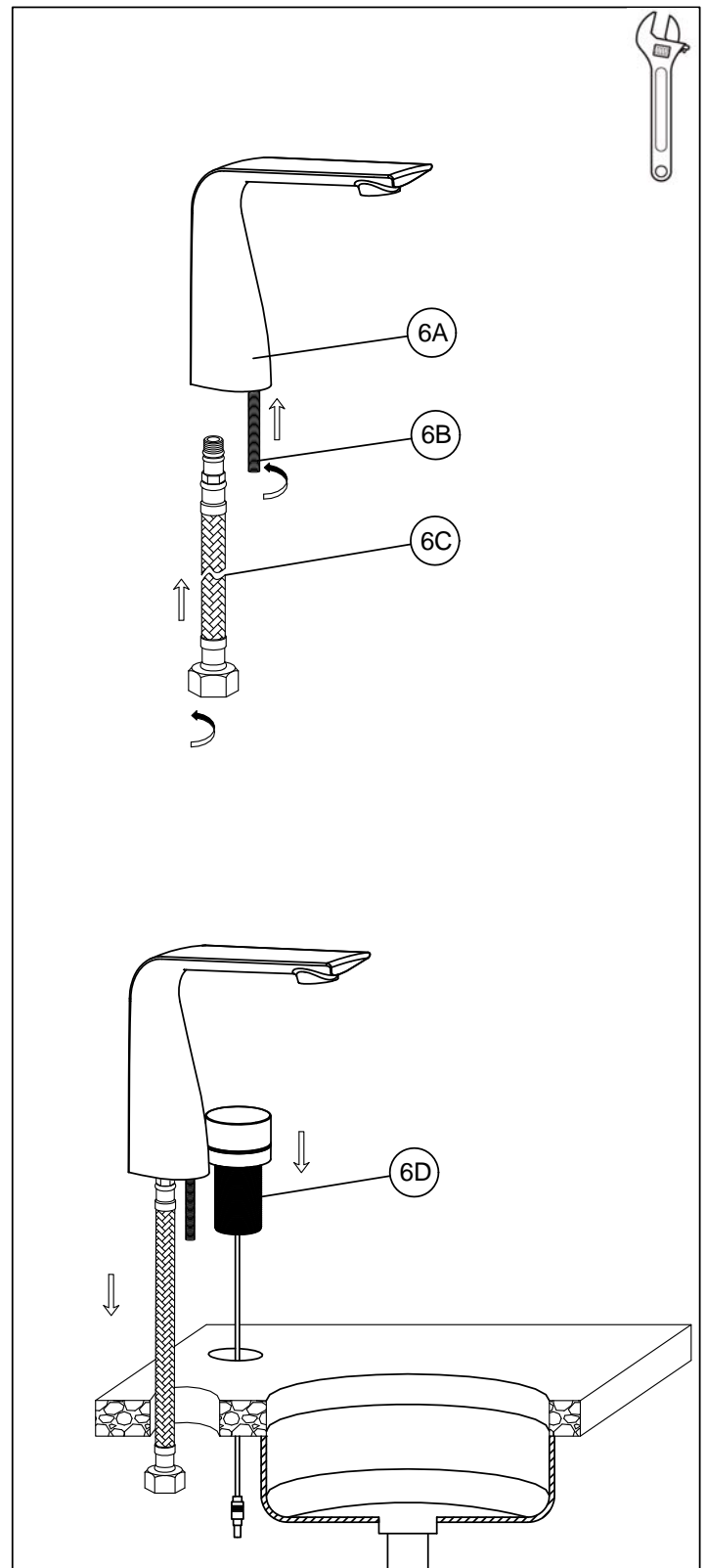

7 SECURING FAUCET

Under the washbasin, screw the rubber gasket (7D), stator (7E) and long hexagon nut (7F) to the stud bolt (7C) in turns and fix the body (7A) on the table-board. Make sure the salient point of the stator (7D) is up-turned. Finally, fasten the long hexagon nut (7F) with a wrench until it's firm enough. Then screw the rubber gasket (7G), stator (7H) and locknut (7I) to the thread bushing (7B) of the digital handle., and then fix the digital handle (7B) on the table-board. Finally tighten the two screws on the locknut (7I) with a screwdriver.

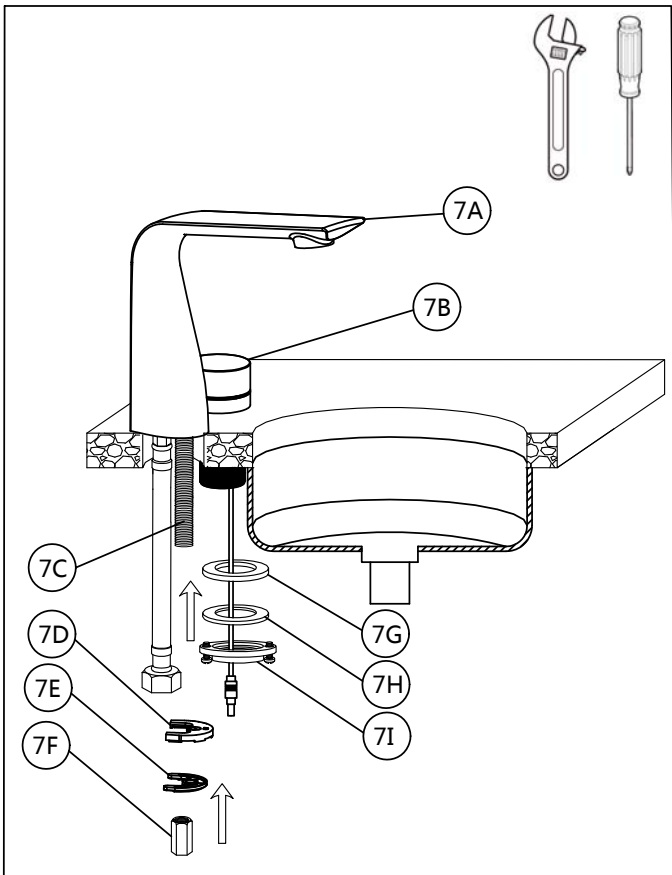

8 REFERENCE DRAWING OF FAUCET HYDROPOWER CONSTRUCTION (NOT 1:1)

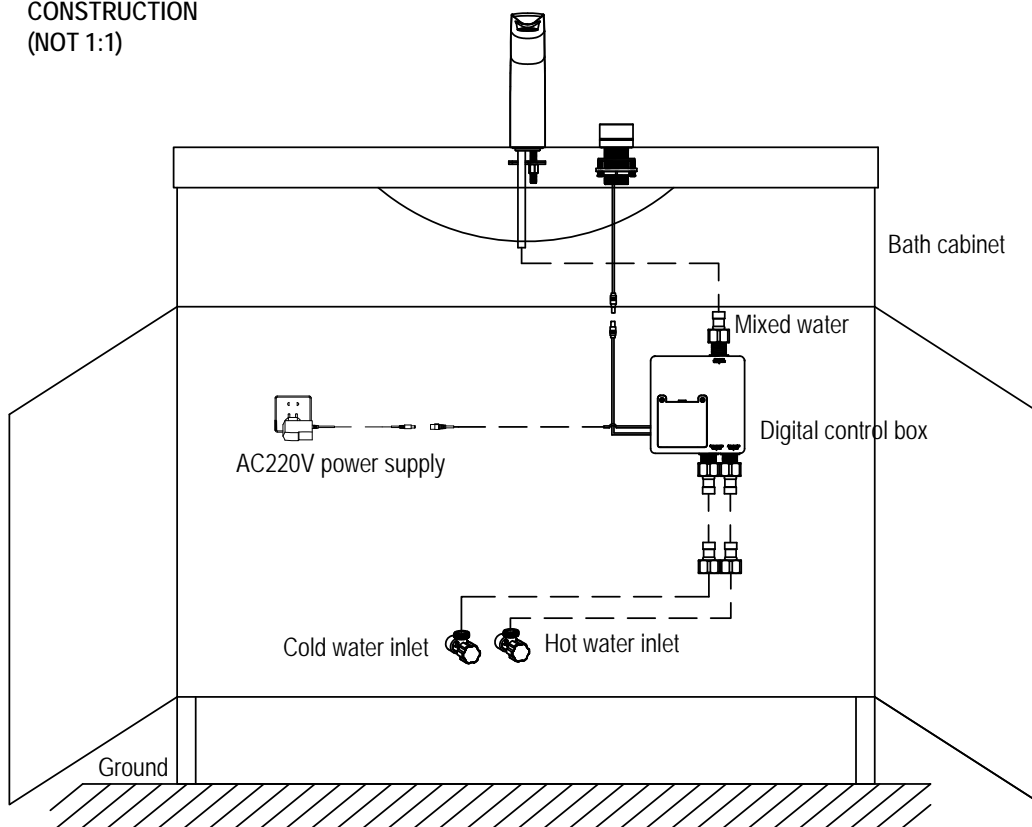

9 WATER TEST

Open the hot and cold valve to check if there is leakage at the junction.

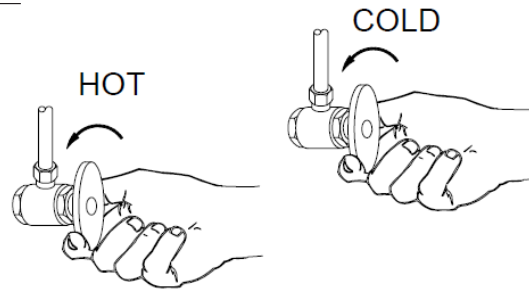

10 Faucet function

10.1 Function Introduction

1 Water temperature setting 2 Flow rate setting 3 SET OPTIONS

10.2 Function description

1. Ready mode

In the power-on state, when all the functions are turned off, the mixer will standby. Light-on in the standby state when the backlight is turned on. Light-off in the standby state when the backlight is turned off.

2. Power on state

In the standby state, press the handle to turn on the mixer. The default constant temperature is 38°C and the default flow level is 4. When the temperature and flow levels are set and saved, the set constant temperature and Flow level work.

3. Shutdown

In the power-on state, short press the handle and turn off the mixer. All the functions and displays are off. When you set timed shutdown, the mixer will be power off automatically. When the scheduled shutdown time is set, the system will automatically shut down once the countdown is over.

4. Water temperature display and setting

After power on, you can adjust the water temperature by rotating the handle. The water temperature will be decreased when rotate the handle by counterclockwise. The water temperature will be increased when rotate the handle by clockwise. And the different lights correspond to the different water temperatures. Hold the handle for 3 seconds to exit the temperature setting mode. Refer to the temperature diagram corresponding to the color band in Figure 1 below. Temperature setting range: 25°C-48°C, after setting the temperature, long press the button for 3 seconds until the light starts to blink, the temperature will be saved.

Holes for the mixer

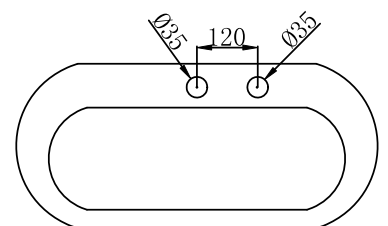

Holes for the holder of digital control box

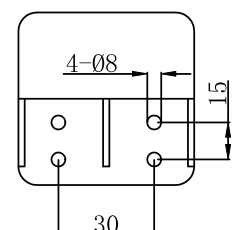

After power on, in the non-temperature setting mode, the lights display the current water temperature. The comparison between the water temperature and the lights is shown in Figure 1 below.

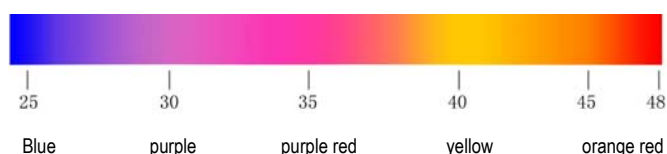

Picture 1

5. Flow rate setting

After power on, press and rotate the button to adjust the flow rate of the faucet. The flow rate will be decreased while pressing and rotating the button by counterclockwise. While pressing and rotating the button, the flow rate will be increased. Flow setting range: 1~8 levels. After changing the flow rate, long press the button for 3 seconds to save the current flow level.

6. Function menu selection

In the standby state, you can enter the first menu option after pressing the button for 3 seconds. Release the button to set the ambient light mode when the light turns to be white. Then you can switch from the on state to off state, or switch from the off state to the on state.

Press and rotate the button until the white light starts to blink, and then hold the button for 3 seconds until the yellow light starts to blink and release the button. Then you can set the boot time for 1 min. That is to say, the digital mixer will be shut down automatically after 1 min.

Press and rotate the button until the green light starts to blink, and then hold the button for 3 seconds until the green light starts to blink and release the button. Then you can set the boot time for 5 mins. That is to say, the digital mixer will be shut down automatically after 5 mins.

Press and rotate the button until the yellow light starts to blink, and then hold the button for 3 seconds until the purple light starts to blink and release the button. Then you can set the boot time for 10 mins. That is to say, the digital mixer will be shut down automatically after 10 mins.

Press and rotate the button until the purple light starts to blink, and then hold the button for 3 seconds until the sky-blue light starts to blink and release the button. Then you can set Wifi configuration mode function.

Press and rotate the button until the sky-blue light starts to blink, and then hold the button for 3 seconds until the light yellow light starts to blink and release the button. It will reset to the factory settings, the ambient light will be turned on, and the default temperature is 38°C, The default effluent flow is level 4, and the boot time is 5 minutes by default.

9. Technical parameters

Working conditions and characteristics					
Nominal voltage	AC220	Rated frequency	50Hz	Nominal voltage	Nominal voltage
Insulation resistance	>20MΩ	waterproof rate	IPX4		
Load configuration odd					
Load category	Rated load voltage	Rated load frequency		Specified load power	other
Flow valve	DC12V	—		1W	—
Thermostatic valve	DC12V	—		2W	—

11 How to clean the aerator

To prevent the impurities impact the efficiency of the aerator, we suggest to clean the aerator as the below picture shows.

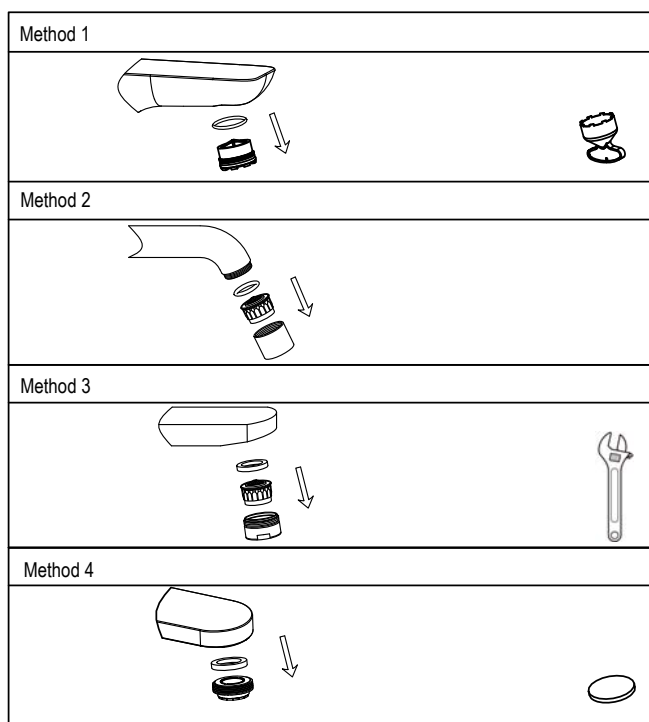

12 REPLACEMENT PARTS

Part Name	Part Drawing		
Flexible hoses			
AERATOR			

7. Over-temperature protection

After power on, the digital mixer will be automatically shutdown if the water temperature exceeds 49°C for 3 seconds in the non-thermal sterilization state.

8. Fault indication

"F1" power-off protection, the battery will offer the power when in power failure. When the battery ran out, the red light flashes one time within 10 seconds of shutdown, then disconnects for 2 seconds, and repeat the cycle. After 10 seconds of shutdown, the standby indication is restored.

"F2" temperature sensor failure, when the outlet temperature sensor failure is abnormal, the orange light flashes one time, then turns off for 2 seconds, and repeat the cycle.

"F3" data communication failure, when the communication failure occurs between the control panel (button) and the faucet, the purple light flashes one time, then turns off for 2 seconds, and repeat the cycle.

**CAUTION: Maintenance****DISASSEMBLY:**

1. Replacement parts may be available at the store where you purchased your faucet.
2. When replacement parts are not available, please write or call our customer service.
3. Always turn off water and relieve pressure before working on your faucet.

**NOTE: Trim Care****Cleaning Instructions:**

For all Handles and decorative finishes, use only a soft damp cloth to clean and shine. Use of polish, detergents, abrasive cleaners, organic solvents or acid may cause damage. Use of other than a soft damp cloth will nullify our warranty!

Special Trim:

Trim products which contain Porcelain or other similar substance are not acceptable for public areas or Commercial use. Installation of Said Trim is at Users Risk!